



# Asian American and Pacific Islander Educators Network

Hybrid Meeting

Monday, November 6, 2023

4:30 - 6:00 p.m.

<https://www.sccoe.org/sclis/aapi>



# Emergency Preparedness



- Identify CPR/First Aid-Certified individuals in the room
- For emergencies, dial **9-1-1** from a landline



- Notify SCCOE Staff if you require assistance exiting
- A wheelchair is available (1<sup>st</sup> Floor, North Building)



- [See the complete Emergency Plan on the SCCOE Website](#)

# Emergency Evacuation Site

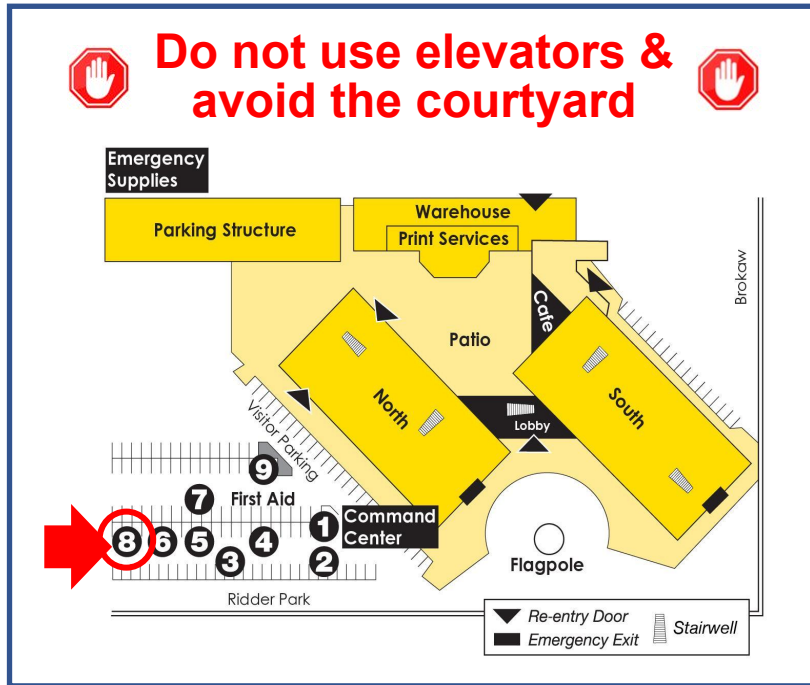

- Presenter to point out **Assembly Area 8**, 2 stairwells/exits
- Follow staff to vacate the building
- Join your group in the parking lot at Assembly Area 8
- Do not go to your car or leave the parking lot until attendance reporting is completed

# Emergency Devices

Emergency devices are located on each floor at the south end of the walkways connecting North and South buildings



Fire Extinguishers



Automated External Defibrillator (AED)



Narcan Naloxone Nasal Spray

# Leadership, Service, & Advocacy

## County Superintendent of Schools



Dr. Mary Ann Dewan

## County Board of Education



Maimona Afzal Berta  
Area 6



Victoria Chon  
Area 5



Joseph Di Salvo  
Area 4



Raena Lari  
Area 7



Grace Mah  
Area 1



Don Rocha  
Area 3



Tara Sreekrishnan  
Area 2

# Agenda

**I. Welcome**

**II. Facilitated Discussion:** *Supporting the Mental Health of Our AAPI Students Through a Cultural Lens*

**III. Discussion and Reflection**

**IV. Networking & Dinner**

# Land Acknowledgment

*We acknowledge that Santa Clara County schools and districts occupy the unceded territory of the [Muwekma Ohlone Nation](#), the sovereign nation and original people of the skies, land, and waters where we work. It is vitally important that we not only come to understand the history of this land, but that we recognize that the Muwekma Ohlone people are living and flourishing within Santa Clara County communities.*

# Statement of Solidarity

**The Santa Clara County Office of Education (SCCOE) in collaboration with the Asian American and Pacific Islander Educators Network affirms its commitment to...**

- creating inclusive, affirming, and equitable school environments for each and every Asian American and Pacific Islander student, family, and staff of our Santa Clara County schools. This statement thus provides rationale and a foundation for operationalizing equity and social justice at the systems level for the Asian American and Pacific Islander students, families, and staff who make up our school communities.
- recognizing that the broad categories of “Asian American” and “Pacific Islander”, [when disaggregated](#), encompass a diversity of cultures, languages, religions, histories, geographical ties, immigration status, socio-economic backgrounds, and generations among over 50 ethnic groups, comprising almost [90,000 K-12 students](#) (35.3%) across Santa Clara County.



# Introductions

**HELLO**  
my name is

- Name
- Role
- District
- One Word

**Use *one* word  
to describe  
how you feel  
right now.**



# Facilitated Discussion

Supporting the Mental Health of Our AAPI Students  
Through a Cultural Lens

# Discussion Moderator



**Gena Pacada**

Coordinator of Makerspace Training

# Topic Professionals



## **Anokh Sohal, D.O.**

Psychiatrist and associate physician  
Department of Behavioral Sciences and Psychiatry at UC  
Davis Health



## **Kook Yin, Psy.D**

Licensed Clinical Psychologist and Interim Supervisor  
Asian Americans for Community Involvement



## **Duy Nguyen, LMFT**

Program Manager  
allcove Palo Alto Center

# Discussion: *Supporting the Mental Health of Our AAPI Students Through a Cultural Lens*

- **Discussion Question 1**

- What are the unique mental health challenges that AAPI students face in educational settings, and how can schools better understand and address these challenges?



# Discussion: *Supporting the Mental Health of Our AAPI Students Through a Cultural Lens*

- **Discussion Question 2**

- Are there specific cultural factors within the AAPI community that contribute to mental health stigma, and how can schools work to reduce this stigma?

# Discussion: *Supporting the Mental Health of Our AAPI Students Through a Cultural Lens*

- **Discussion Question 3**

- What strategies or resources can schools provide to support AAPI students' mental health needs, considering the diverse cultural backgrounds within the AAPI community? How can others access your services?



**Discussion**



**Reflection**



# Discussion and Reflection

- What are the perceptions of Asian American youth?
- Why is it important to understand the narratives of Asian American students?
- What can you do as educators to respond to the needs of Asian American youth?

# Networking and Dinner

*Enjoy!*



# Planning Committee Members

- Francesca Lomotan, Santa Clara County Office of Education
- Kasturi Basu, Alum Rock Union School District
- Keysha Doutherd, Santa Clara County Office of Education
- Dr. Hong Nguyen, San Ramon Valley Unified School District
- Joanna Shea, East Side Union High School District
- Jessica Simpson, Santa Clara County Office of Education
- Jas Sohal, Santa Clara County Office of Education
- Tina Tong Choy, Berryessa Union School District
- Dr. Yee Wan, Santa Clara County Office of Education



# Please Provide Feedback

<https://www.surveymonkey.com/r/aapien110623>

THANK YOU!



# 2023-24 Hybrid Network Meetings

4:30 to 6:00 p.m.

February 8, 2024

May 6, 2024



[Invite your colleagues to register!](#)



# **Jessica Simpson, Ed.S.**

Director, School Climate, Leadership  
& Instructional Services

Professional Learning & Support Division

[jsimpson@sccoe.org](mailto:jsimpson@sccoe.org)

(408) 453-4444

# Santa Clara County Office of Education

Working collaboratively with school and community partners, the **Santa Clara County Office of Education (SCCOE)** is a regional service agency committed to serving, inspiring, and promoting student and public school success. The SCCOE is a premier service organization driven by the core principles of equity, diversity, inclusion, and partnership.

For more information about the Santa Clara County Office of Education, please visit [www.sccoe.org](http://www.sccoe.org)



@SCCOE



@santaclarasccoe



@santa-clara-county-office-of-education